

# PROFILE ELTEX

ELTEX PROFILES

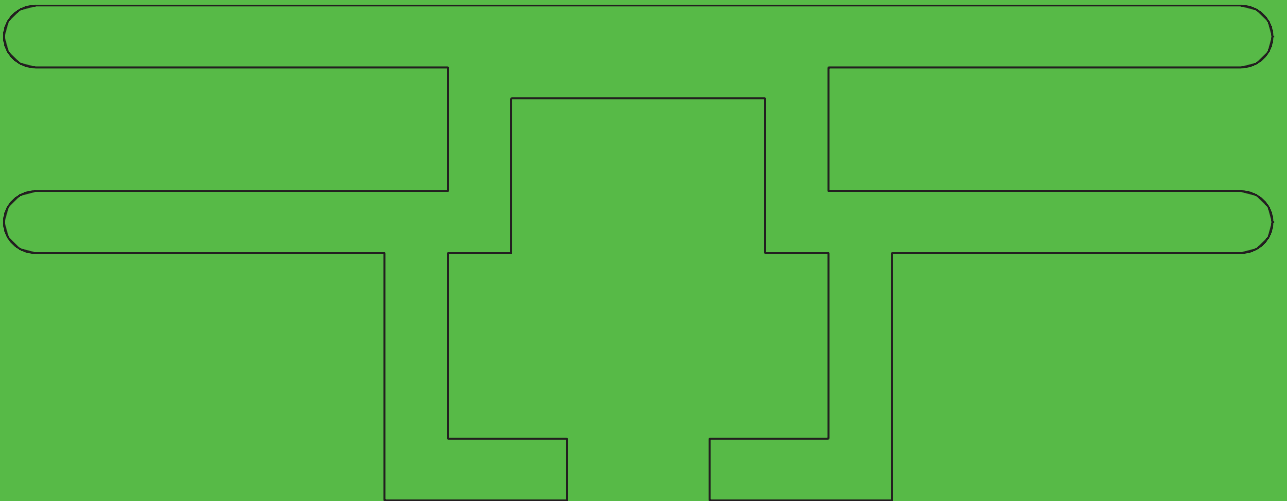



**profil eltex 16**

profil eltex 16

04.001

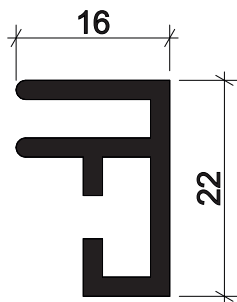

Material: aluminium anodowane, satynowane  
Kolor: naturalny lub RAL  
Waga: 0,35 kg/mb

Material: aluminium satin, anodised  
Color: natural or RAL palette  
Weight: 0,35 kg/mb



**profil eltex 40**

profil eltex 40

04.004

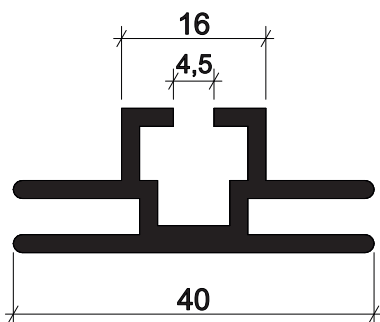

Material: aluminium anodowane, satynowane  
Kolor: naturalny lub RAL  
Waga: 0,58kg/mb

Material: aluminium satin, anodised  
Color: natural or RAL palette  
Weight: 0,58 kg/mb



**profil eltex S 40**

profil eltex S40

04.003

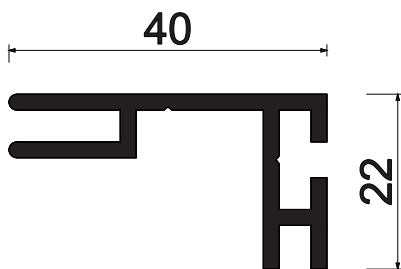

Material: aluminium anodowane, satynowane  
Kolor: naturalny lub RAL  
Waga: 0,53 kg/mb

Material: aluminium satin, anodised  
Color: natural or RAL palette  
Weight: 0,53 kg/mb



**profil eltex 50**

profil eltex 50

04.005

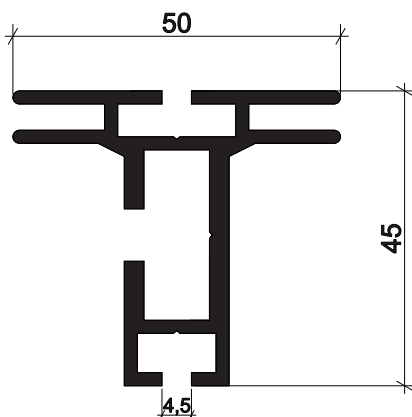

Material: aluminium anodowane, satynowane  
Kolor: naturalny lub RAL  
Waga: 1,14 kg/mb

Material: aluminium satin, anodised  
Color: natural or RAL palette  
Weight: 1,14 kg/mb



### profil eltex S 60

profil eltex S 60

Material: aluminium anodowane, satynowane  
Kolor: naturalny lub RAL  
Waga: 0,75 kg / mb

04.008

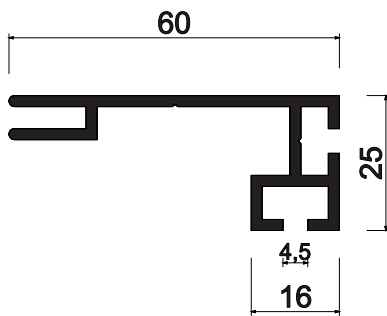

Material: aluminium satin, anodised  
Color: natural or RAL palette  
Weight: 0,75 kg/mb



### profil eltex magnetic

profil eltex magnetic

Material: aluminium anodowane, satynowane  
Kolor: naturalny lub RAL  
Waga: 1,61 kg/mb

04.009

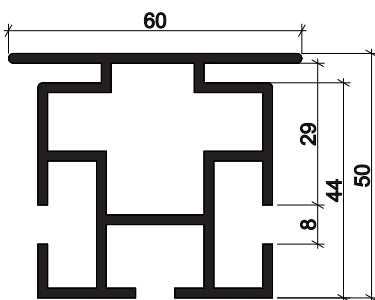

Material: aluminium satin, anodised  
Color: natural or RAL palette  
Weight: 1,61 kg/mb



### profil eltex cube

profil eltex cube

Material: aluminium anodowane, satynowane  
Kolor: naturalny lub RAL  
Waga: 2,01 kg/mb

04.006

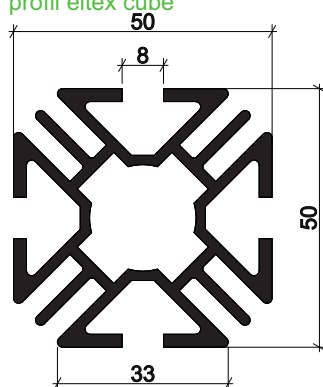

Material: aluminium satin, anodised  
Color: natural or RAL palette  
Weight: 2,01 kg/mb



### profil eltex 82

profil eltex 82

Material: aluminium anodowane, satynowane  
Kolor: naturalny lub RAL  
Waga: 1,26 kg/mb

04.011

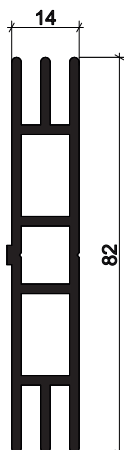

Material: aluminium satin, anodised  
Color: natural or RAL palette  
Weight: 1,26 kg/mb



**profil eltex cover**

profil eltex cover

04.016

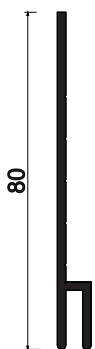

Material: aluminium anodowane, satynowane  
Kolor: naturalny lub RAL  
Waga: 0,53 kg/mb

Material: aluminium satin, anodised  
Color: natural or RAL palette  
Weight: 0,53 kg/mb



**profil eltex edge**

profil eltex edge

04.017

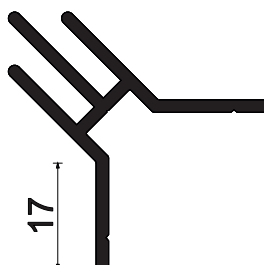

Material: aluminium anodowane, satynowane  
Kolor: naturalny lub RAL  
Waga: 0,57 kg/mb

Material: aluminium satin, anodised  
Color: natural or RAL palette  
Weight: 0,57 kg/mb



**profil eltex corner**

profil eltex corner

04.018

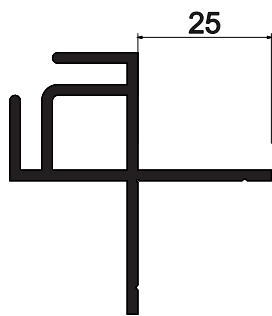

Material: aluminium anodowane, satynowane  
Kolor: naturalny lub RAL  
Waga: 0,82 kg/mb

Material: aluminium satin, anodised  
Color: natural or RAL palette  
Weight: 0,82 kg/mb



**profil eltex 122**

profil eltex 122

04.013

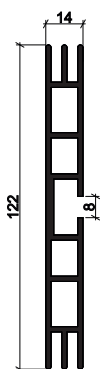

Material: aluminium anodowane, satynowane  
Kolor: naturalny lub RAL  
Waga: 1,8 kg/mb

Material: aluminium satin, anodised  
Color: natural or RAL palette  
Weight: 1,8 kg/mb

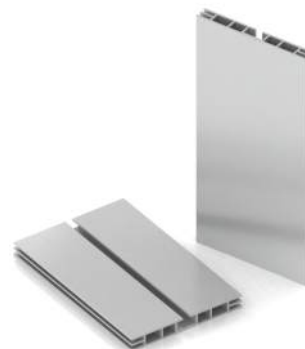

## profil eltex 150

profil eltex 150

04.014

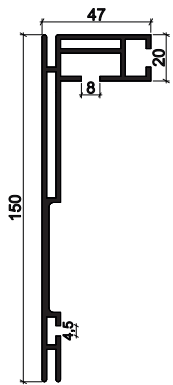

Material: aluminium anodowane, satynowane  
Kolor: naturalny lub RAL  
Waga: 2,2 kg/mb

Material: aluminium satin, anodised  
Color: natural or RAL palette  
Weight: 2,2 kg/mb



## profil eltex 200

profil eltex 200

04.015

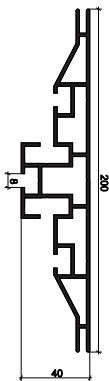

Material: aluminium anodowane, satynowane  
Kolor: naturalny lub RAL  
Waga: 3,35 kg/mb

Material: aluminium satin, anodised  
Color: natural or RAL palette  
Weight: 3,35 kg/mb



## profil eltex keder fi 32

profil eltex keder fi 32

04.020

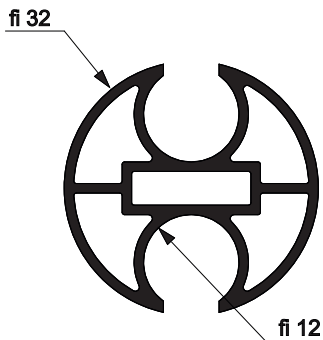

Material: aluminium anodowane, satynowane  
Kolor: naturalny lub RAL  
Waga: 0,62 kg/mb

Material: aluminium satin, anodised  
Color: natural or RAL palette  
Weight: 0,62 kg/mb



## profil eltex keer fi 50

profil eltex keder fi 50

04.021

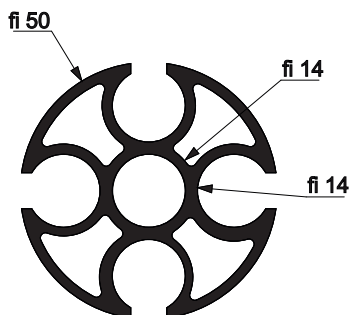

Material: aluminium anodowane, satynowane  
Kolor: naturalny lub RAL  
Waga: 1,71 kg/mb

Material: aluminium satin, anodised  
Color: natural or RAL palette  
Weight: 1,71 kg/mb



**profil eltex 30 S**  
profil eltex 30 S

04.002

Material: aluminium anodowane, satynowane  
Kolor: naturalny lub RAL  
Waga: 2,2 kg/mb

Material: aluminium satin, anodised  
Color: natural or RAL palette  
Weight: 2,2 kg/mb



**profil eltex 50 EF**  
profil eltex 50EF

04.007

Material: aluminium anodowane, satynowane  
Kolor: naturalny lub RAL  
Waga: 1,05 kg/mb

Material: aluminium satin, anodised  
Color: natural or RAL palette  
Weight: 1,05 kg/mb



**profil eltex 80 S**  
profil eltex keder fi 32

04.010

Material: aluminium anodowane, satynowane  
Kolor: naturalny lub RAL  
Waga: 1,34 kg/mb

Material: aluminium satin, anodised  
Color: natural or RAL palette  
Weight: 1,34 kg/mb



**profil eltex 100 S**  
profil eltex keder fi 50

04.012

Material: aluminium anodowane, satynowane  
Kolor: naturalny lub RAL  
Waga: 1,02 kg/mb

Material: aluminium satin, anodised  
Color: natural or RAL palette  
Weight: 1,02 kg/mb



### adapter keder 38/16

adapter keder 38/16

04.022

Material: aluminium anodowane  
Waga: 57,6 g

Material: aluminium anodised  
Weight: 57,6 g

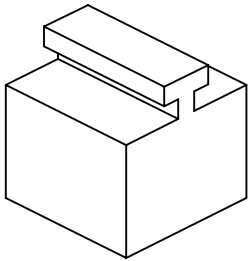

### kątownik eltex 82, 122

adjustable left shelf bracket

04.023

Material: aluminium anodowane  
Waga: 20,5 g

Material: aluminium anodised  
Weight: 20,5g

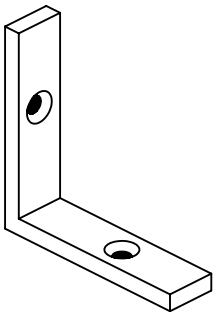

### łączenie eltex 16 z MX 80

04.024

Material: aluminium anodowane  
Waga: 9 g

Material: aluminium anodised  
Weight: 9 g

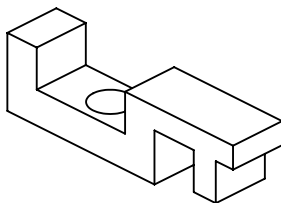

### łącznik kątowy eltex 16

right hinge

04.025

Material: stal ocynkowana  
Waga: 26,9 g

Material: zink coated steel  
Weight: 26,9 g

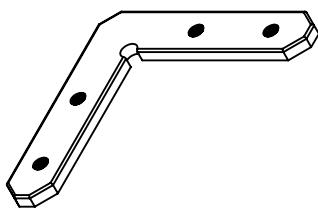



## profil eltex keder 38/16

04.019

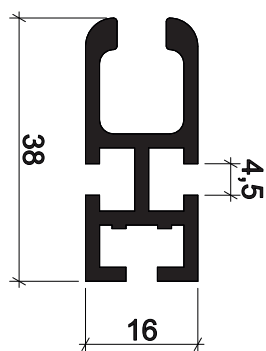

Material: aluminium anodowane, satynowane  
Kolor: naturalny lub RAL  
Waga: 0,7 kg/mb

Material: aluminium satin, anodised  
Color: natural or RAL palette  
Weight: 0,7 kg/mb



### łącznik kątowy eltex 40

04.026

Material: aluminium anodowane  
Waga: 16,9 g

Material: aluminium anodised  
Weight: 16,9 g

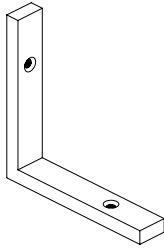

### łącznik kątowy eltex 50.150.200 bez gwintu

04.027

Material: stal ocynkowana  
Waga: 103,3 g

Material: zink coated steel  
Weight: 103,3 g

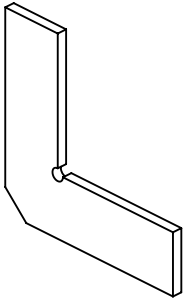

### łącznik kątowy eltex 50.150.200

04.028

Material: stal ocynkowana  
Waga: 102 g

Material: zink coated steel  
Weight: 102 g

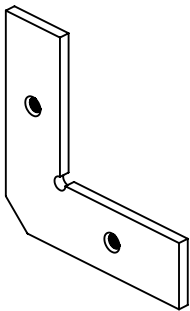

### łącznik kątowy cube right hinge

04.029

Material: stal ocynkowana  
Waga: 51,2 g

Material: zink coated steel  
Weight: 51,2 g

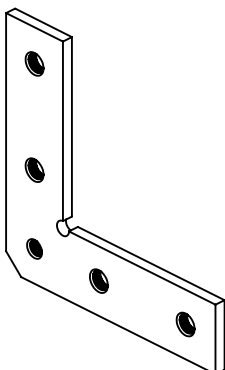

łącznik prosty eltex 16

04.030

Material: stal ocynkowana  
Waga: 26,7 g

Material: zink coated steel  
Weight: 26,7 g

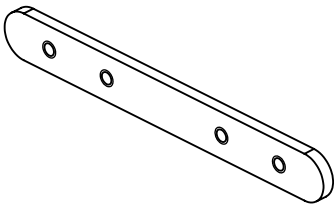

łącznik prosty eltex bez gwintów

04.031

Material: stal ocynkowana  
Waga: 155,5 g

Material: zink coated steel  
Weight: 155,5 g

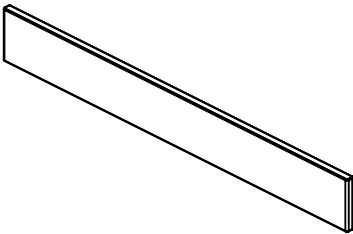

łącznik prosty eltex

04.032

Material: stal ocynkowana  
Waga: 154,7 g

Material: zink coated steel  
Weight: 154,7 g

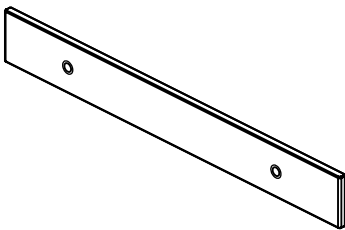

łącznik prosty eltex keder fi 32 łuk

04.033

Material: stal ocynkowana  
Waga: 33 g

Material: zink coated steel  
Weight: 33 g

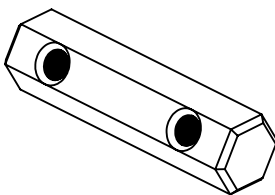

### łącznik prosty eltex keder fi 32

04.034

Materiał: stal ocynkowana  
Waga: 69,4 g

Material: zink coated steel  
Weight: 69,4 g

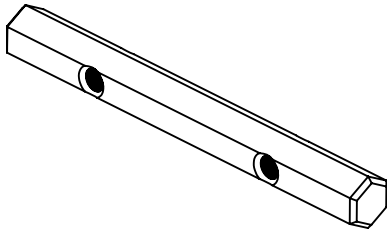

### łącznik prosty eltex keder 38x16

04.035

Materiał: stal ocynkowana  
Waga: 151,5 g

Material: aluminium anodised  
Weight: 151,5 g

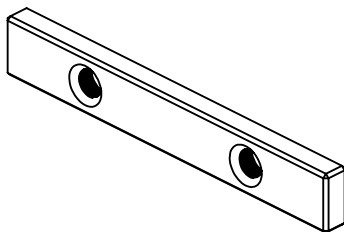

### nakrętka z uchem

04.036

Materiał: stal ocynkowana  
Waga: 708,5 g

Material: zink coated steel  
Weight: 708,5 g

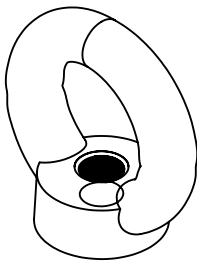

### podstawa 400x80

04.037

Materiał: stal malowana proszkowo  
Kolor: RAL 9006  
Waga: 1474,3 g

Material: powder coated steel  
Color: RAL 9006  
Weight: 1474,3 g

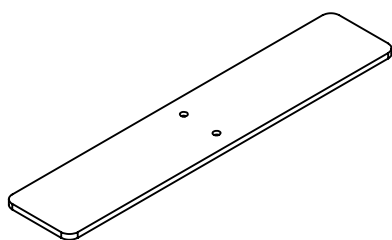

## podstawa 500x80

04.038

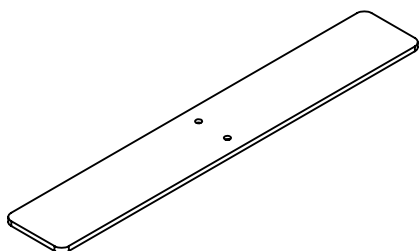

Materiał: stal malowana proszkowo  
 Kolor: RAL 9006  
 Waga: 1861 g

Material: powder coated steel  
 Color: RAL 9006  
 Weight: 1861 g



## podstawa 600x100

04.039

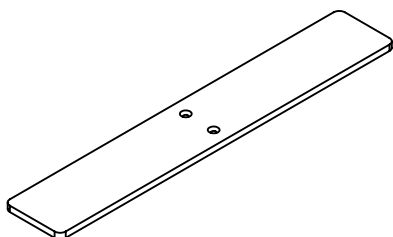

Materiał: stal malowana proszkowo  
 Kolor: RAL 9006  
 Waga: 4661 g

Material: powder coated steel  
 Color: RAL 9006  
 Weight: 4661 g



## Złożenie narożnik eltex cube

04.040

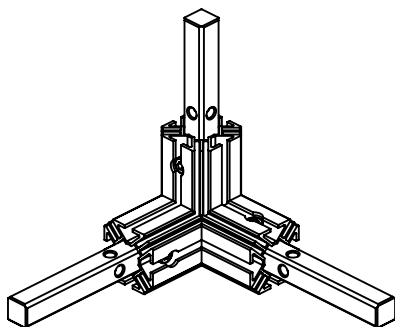

Materiał: aluminium anodowane,  
 stal ocynkowana  
 Waga: 1950,5 g

Material: aluminium anodised,  
 zink coated steel  
 Weight: 1950,5 g



## śruba z uchem

04.041

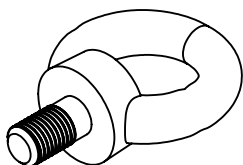

Materiał: stal ocynkowana  
 Waga: 53,5 g

Material: zink coated steel  
 Weight: 53,5 g



linki do ślizgaczy

06.042

ogniwo

06.043

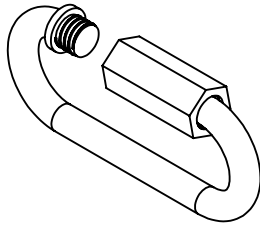

Material: Stal  
Kolor: RAL 9006  
Waga: 24 g

Material: steel  
Color: RAL 9006  
Weight: 24 g



podstawa boczna

06.044